

**PEACE WAPITI PUBLIC SCHOOL DIVISION NO. 76**  
 EDUCATING TODAY FOR SUCCESS TOMORROW

# WARD No.9

## Clairmont & Bezanson

**LEGEND:**

- Primary Divided Highway
- Primary Highway
- Secondary Highway
- School Attendance Boundary
- Township & Range Road
- Township Borders
- Hamlet / Village
- School



**TOWNSHIP LAYOUT GUIDE**

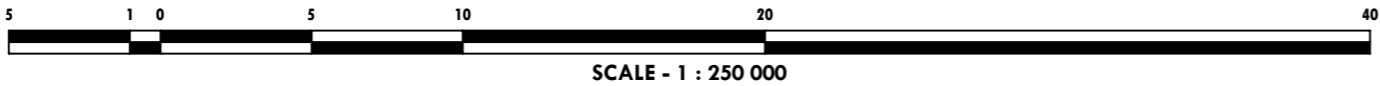
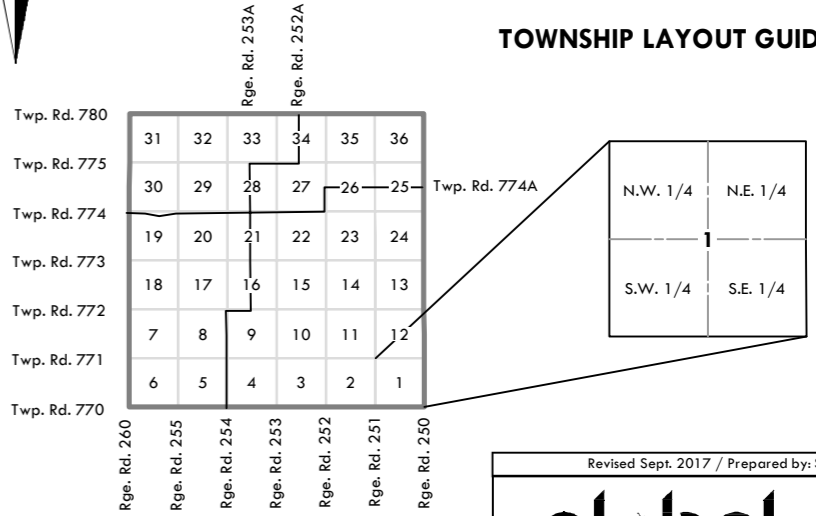

SCALE - 1 : 250 000

Revised Sept. 2017 / Prepared by: SMP

Ph: 780.532.2343 www.globalraymac.ca